

CANpro USB

High Speed USB to CAN Interface Card for Mobile Use

- Top performing and fast access to CAN / CANopen networks
- Suitable for a wide variety of CAN and CANopen applications
- Integration of applications like control, measurement, configuration and analysis tasks

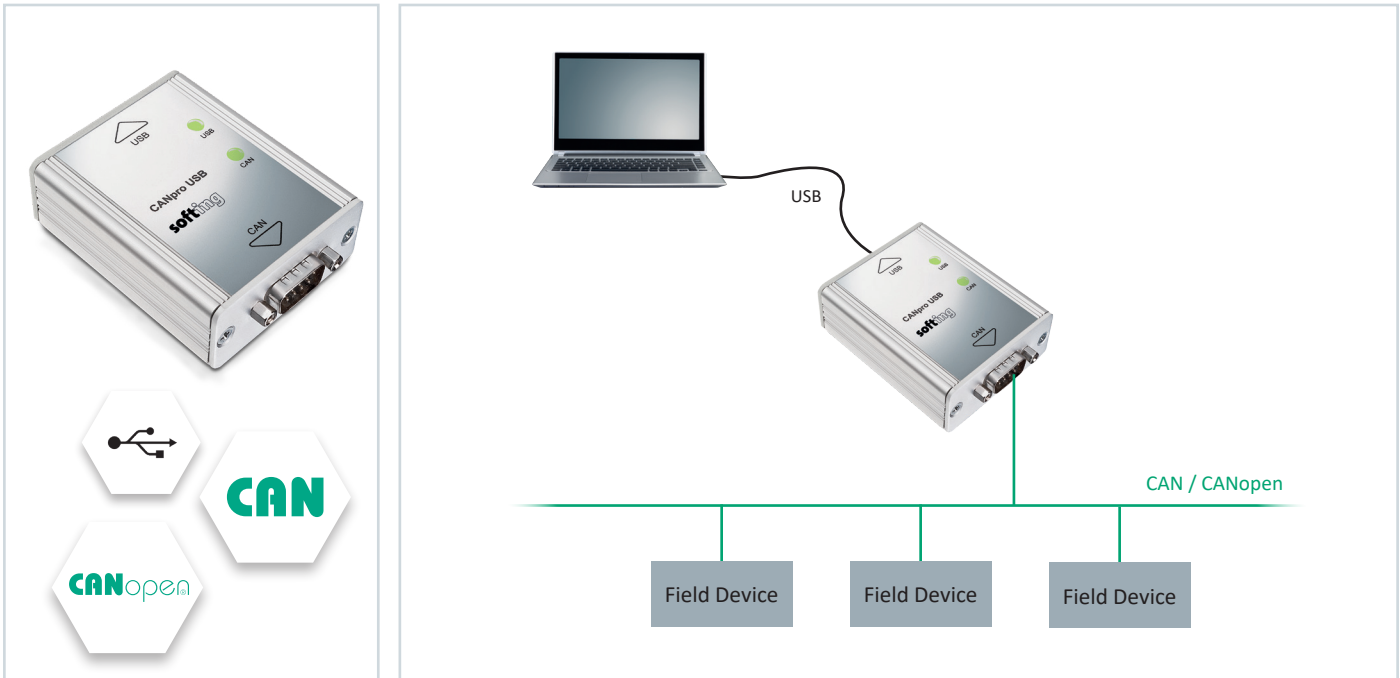

High data throughput resulting in short response time

- Single channel CAN interface card with USB 2.0 high speed connector
- Processor and speed-optimized firmware designed for 100% bus load at 1 Mbit/s
- High data throughput and very short response times of 100 μ s to 500 μ s
- Suitable for running wide variety of applications, including time-critical ones
- Time stamp for CAN messages (1 μ s resolution, \pm 10 μ s Jitter)
- Easy-to-use
- USB and CAN status shown by LEDs
- Easy installation by simply connecting USB cable to PC and D-Sub connector to CAN network
- No power supply required

Suitable for in-house or mobile usage

- Small but robust metal housing suited for everyday use
- Heavy duty version offering extensive temperature range (-20°C ... 70°C) and lockable USB cable connector with special mounting kit for fixing to PC, ideal for mobile use in harsh industrial environments

Comprehensive functionality supporting a wide variety of use cases

- Easy integration into CAN applications
- Numerous free-of-charge programming interfaces:
 - CAN C-API supporting various operating modes (FIFO and Object Buffer)
 - CAN.NET API
 - CANopen client API

CANpro USB

Technical Data

CAN protocol and available APIs	CAN V2.0 (11/29 Bit-IDs) CAN API CANopen Client API
---------------------------------	---

Bus Connection

Connector	9-pin D-sub male
Galvanically isolated	Yes
Physical layer	ISO 11898-2 (CAN High Speed)

PC Interface	USB 2.0 High Speed, 480 Mbit/s
--------------	--------------------------------

Indicators

USB LED	USB status
CAN LED	CAN status

Operation Temperature	0 °C ... +55 °C (standard version) / -20 °C ... +70 °C (heavy duty version)
-----------------------	---

Storage Temperature	-20 °C ... +70 °C (standard version) / -20 °C ... +70 °C (heavy duty version)
---------------------	---

Relative Humidity	< 90 %, non-condensing
-------------------	------------------------

Dimensions	74 mm x 55 mm x 26 mm
------------	-----------------------

Power Supply

Supply Voltage	5 VDC (±5 %) via USB connector
Current Consumption	Typically 200 mA

Drivers Available for	Windows XP, Windows 7, Windows 8, Windows 10, Linux
-----------------------	---

Conformity



Scope of Delivery

Hardware (Standard Version)	CANpro USB (standard version), USB cable
Hardware (Heavy Duty Version)	CANpro USB (heavy duty version), lockable USB cable with cable connector and mounting kit
Software	Drivers, APIs, sample programs on CD-ROM
Documentation	Manual on CD-ROM

Order Numbers

DUL-OO-012410	CANpro USB (standard version)
DUL-OO-012411	CANpro USB (heavy duty version)

Your local Softing contact:

<http://industrial.softing.com>

optimize!
softing